

# Alecto

CE

## DOM005T

Timbre inalámbrico adicional  
para timbre smart DOM005

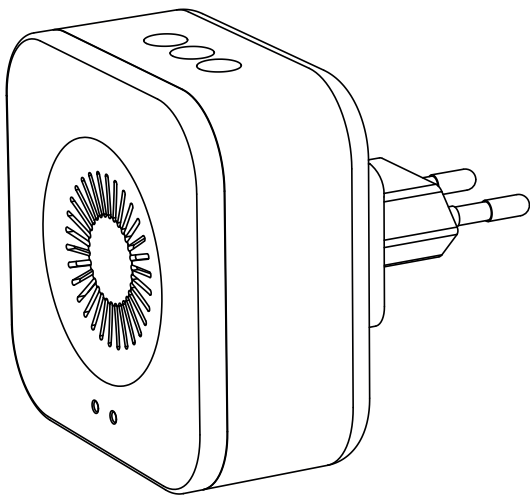

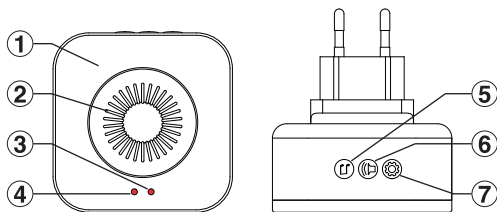

1. Carcasa
2. Altavoz
3. Luz indicadora de estado
4. Luz indicadora de encendido
5. Selección de melodía
6. Ajuste de volumen
7. Botón de registro

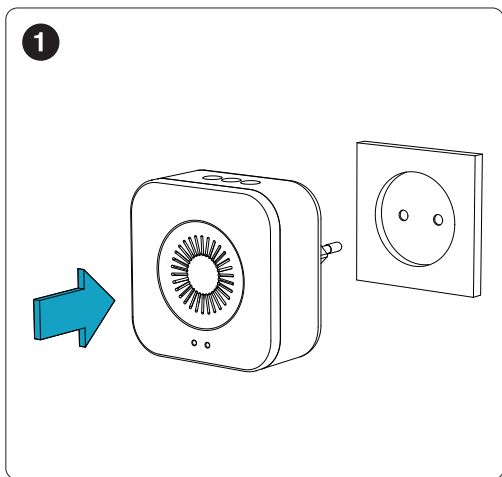

Max. 35 sec.

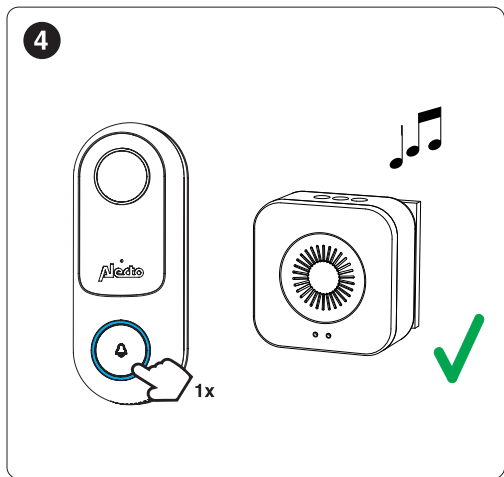
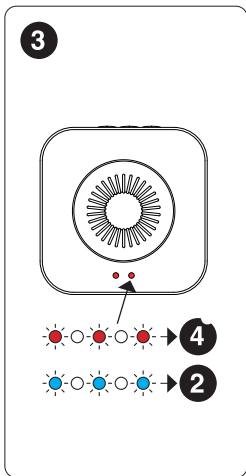
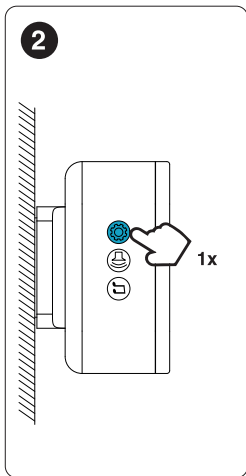

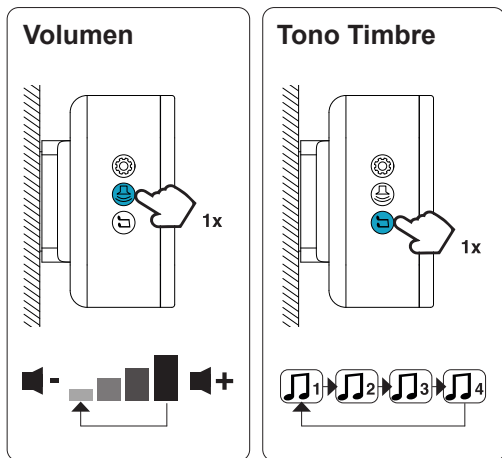

## ESPECIFICACIONES

Canal de Transmisión	RF
Frecuencia	433MHz
Entorno	Uso en interiores
Voltaje de entrada	220~240VAC 50Hz
Dimensiones	75x75x80mm
Rango de trabajo	Hasta 50m

### DECLARATION OF CONFORMITY

Hereby, Hesdo declares that the product Alecto SMART-RING-BELL is in compliance with directive 2014/53/EU.

The full text of the EU declaration of conformity is available at the following internet address: <http://DOC.hesdo.com/SMART-RING-BELL-DOC.pdf>